



D21 DKH

IP VIDEO DOOR STATION

For multi-tenant residences and buildings with up to 100 units
Display Module • Keypad Module

ANSWER YOUR DOOR ANYWHERE.



ADVANTAGES

HOW DOES IT WORK?

Imagine, you are not at home and your children have locked themselves out or the courier wants to deliver a parcel. With DoorBird this is no longer a problem. Every time someone rings the doorbell you will get a push notification on your smartphone or tablet. Via the DoorBird App you are not only able to talk to the visitor but also see them live in HD quality. You will never miss a visitor again. With DoorBird you are on the move and yet at home, even if a burglar rings at the door to check if someone is at home.

SMART HOME STARTS AT THE FRONT DOOR

DoorBird is the smart solution for your house entrance. Simply connect your DoorBird IP Video Door Station to your smartphone and talk to your visitor – anywhere you are. The IP Video Door Station can be used as a stand-alone unit or can be integrated into an existing Smart Home platform. Even existing classic installations such as an electric door opener can still be used and controlled via the DoorBird App.

QUALITY MADE IN GERMANY

All DoorBird products are designed, developed and produced by Bird Home Automation GmbH in Berlin, Germany. We manufacture all products with the greatest care and precision, and deliver them to our customers all over the world.



Open API

- Local interface for integration with third-party systems and SIP



Video and audio call

- On smartphones, tablets (iOS, Android), IP and landline phones (SIP)



Smart Transmission Mode (STM)

- Real-time audio / video communication, optimized for mobile devices via WiFi, 3G, 4G, 5G



Smart Home & NVR compatible

- Control4, Loxone, Crestron, Synology, AVM FRITZ!Fon, URC, QNAP, RTI, ELAN, Fibaro, Bang & Olufsen and others



Night vision

- With 12 Infrared LEDs



Automatic door buzzer

- For use in medical offices and office environments

HD HDTV Video

- Ultra wide-angle, hemispheric lens, 180°



Display Module

- Distance sensitivity on/off
- Individually configurable, e.g.: display of the resident directory, welcome message configurable



Individual action schedules, e.g.:

- RFID card "abc" has only access on Wednesday from 9 am until 11 am
- 4D motion sensor switches on external lamp between 9 pm and 6 am



Light sensor

- For night vision mode



Noise reduction and echo cancellation (AEC, ANR)



Two freely configurable bi-stable switching relays

- Two doors or gates can be controlled via App
- Status configurable via App: temporary or permanent circuit



Keypad Module

- Configurable via App
- Individual PIN codes
- Individual events (e.g.: trigger a relay, push notification, ...)



Geofencing

- Automatic door and gate opening when returning home



RFID reader

- Configurable remotely via App (e.g. time frame)



Easy connection to the network

- Connection via a network cable or bell wire via 2-Wire Ethernet PoE Converter "DooBird A1071" (PoE, network data)



Motion sensor with 4D technology

- Distance up to 10 m adjustable via App (interval: 1 m)



Microphone

- Clear voice transmission

TECHNICAL SPECIFICATIONS

GENERAL

Front panel	3 mm (0.12 in) Available in brushed stainless steel V2A / V4A and with Bronze-Finish, V4A
Mounting housing (backbox)	Stainless steel
Mounting type	Flush-mounted, surface-mounting housing sold separately
Power supply	15 V DC (max. 15 W) or Power over Ethernet (PoE 802.3af Mode-A)
Display Module	3.5" LCD (no touch function), illuminated, for the display of a 2-line free text and the name directory (max. 100 entries)
Keypad Module	16 keys, illuminated, configurable via App, e.g. <ul style="list-style-type: none"> Individual PIN codes Individual events (e.g. switch a relay, push notification, SIP call [audio/video], HTTP(s) request) Individual schedules Up to 100 PIN codes manageable
Weight	3043 g
Connectors	<ul style="list-style-type: none"> RJ45, for LAN/PoE Bistable latching relay #1, max. 24 V DC/AC, 1 Ampere, e.g. for electric door opener Bistable latching relay #2, max. 24 V DC/AC, 1 Ampere, e.g. for electric door opener External input for external door opener button 15 V DC input (+, -), max. 15 W Relays can be expanded / detached with DoorBird I/O Door Controller
Weather-proof	Yes, IP65
Approvals	IP65, CE, FCC, IC, RoHS, IK08, REACH, IEC/EN 62368, IEC/EN 62471
Dimensions	256 x 275.25 x 48.75 mm (H x W x D) 10.08 x 10.13 x 1.92 in (H x W x D)
Operating conditions	-25 to +55°C / -13 to 131°F Humidity 10 to 85 % RH (non-condensing)
Scope of delivery	1x Main Electrical Unit 1x Front panel 1x Flush-mounting housing (backbox) 1x Power supply unit (mains adaptor) with four country-specific outlet adaptors (110 - 240 V AC to 15 V DC) 1x RFID key fob 1x Screwdriver 1x Quickstart guide with Digital Passport 1x Installation manual 1x Small parts
Warranty	see www.doorbird.com/warranty

CURRENT SYSTEM REQUIREMENTS

System requirements	Mobile device: Newest iOS on iPhone/iPad, newest Android on Smartphone/Tablet Internet: High-Speed Landline Broadband Internet connection, DSL, cable or fiber optic, no socks or proxy server Network: Ethernet Network, with DHCP
Recommended installation height	Camera lens should be at a min. height of 145 cm (57 in). Before the installation please determine your optimal installation height.

VIDEO

Camera	HDTV 720p, dynamic (VGA - HDTV)
Lens	High-end ultra wide-angle hemispheric lens 180° (D), 140° (H), 100° (V), straightened, IR-capable
Night-vision	Yes, light sensor, automatic IR-cut filter, 12 Infrared LEDs (850 nm)

AUDIO

Audio components	Speaker and microphone, noise reduction and echo cancellation (ANR, AEC)
Audio streaming	Two-way, full duplex

NETWORK

Ethernet	RJ45 jack, PoE 802.3af Mode-A, 10/100 Base-T
Supported protocols	HTTP, HTTPS, SSL/TLS, Bonjour, DNS, RTSP, RTP, TCP, UDP, RTCP, ICMP, DHCP, ARP, SIP, DTMF (RTP [RFC-2833], SIP INFO [RFC-2976]), STM

MOTION SENSOR

Type	Active
Detection angle	54° (H), 70° (V)
Range	Since a "Display Module" is connected to the Main electrical unit, the range is limited to 1 m (3.3 ft).
Technology	4D. Based on multiple integrated sensors and algorithms, e.g. Radio Frequency Energy (RFE)

RFID

Type	Active Reader Passive Tag (ARPT) system
Standard	ISO/IEC 18000-2:2009 Part 2, EM4100, EM4102
Frequency	125 KHz
Range	0 - 3 cm, depends on environment
Antenna	Internal
Compatible Transponder	RFID key fobs, sold separately, see www.doorbird.com/buy
Configuration	Up to 100 tags manageable Via App, e.g. <ul style="list-style-type: none"> Tag (add, delete) Individual events (e.g. switch a relay, SIP call [audio/video], HTTP(s) notification) Individual schedules RFID history available for 60 minutes in the app

INTEGRATED WIRELESS MODULES

RFID	125 KHz
Sensor	24 GHz, can be disabled

THIRD-PARTY INTEGRATION (DOORBIRD CONNECT)

Partnerintegrations	see www.doorbird.com/connect
API	see www.doorbird.com/api
Simultaneous video streams	One, for event-based and continuous recording

OPTIONAL ACCESSORIES

Sold separately	see www.doorbird.com/buy
-----------------	--

Special remarks:
 Assembly requires professional skills or a technician.

TECHNICAL DRAWINGS

Front panel material thickness: 3.0 mm (0.12 in)

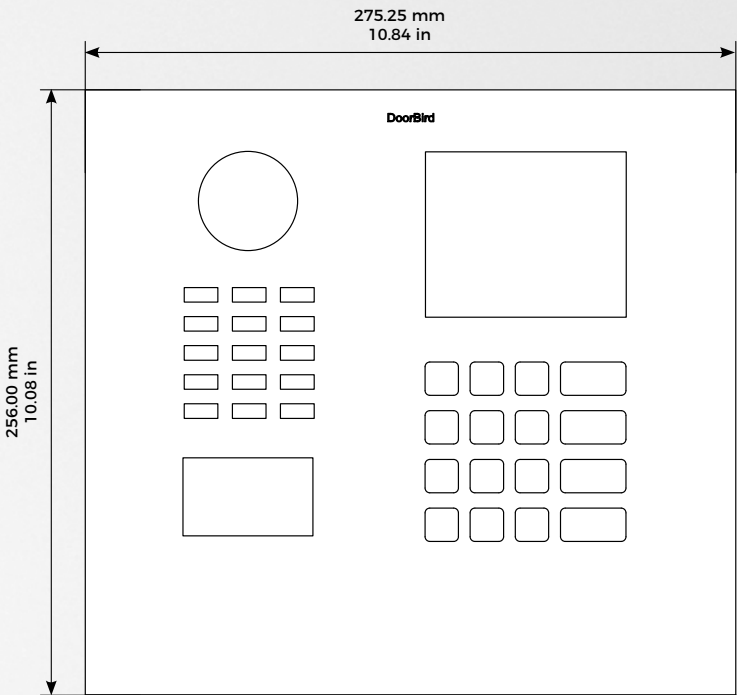

Front panel

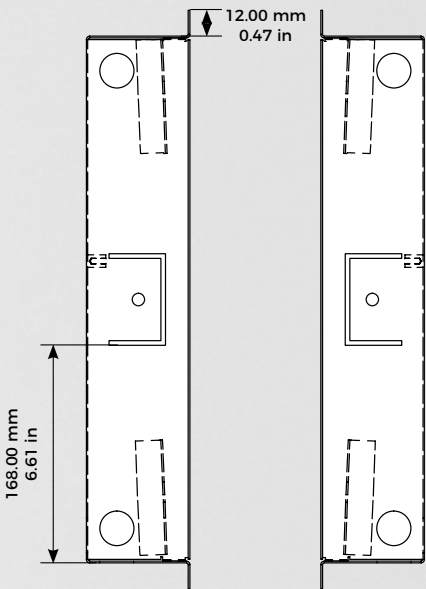

Flush-mounting housing (backbox)

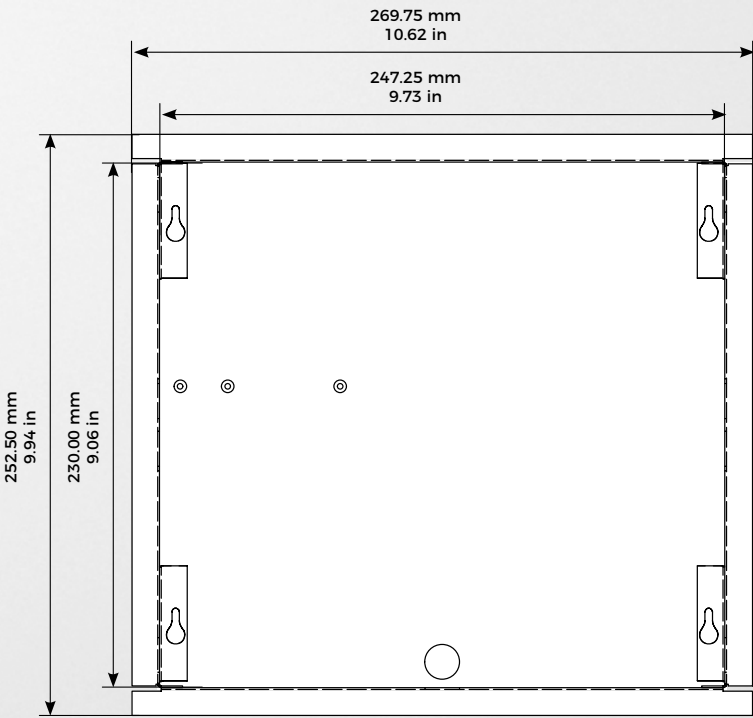

Flush-mounting housing (backbox)

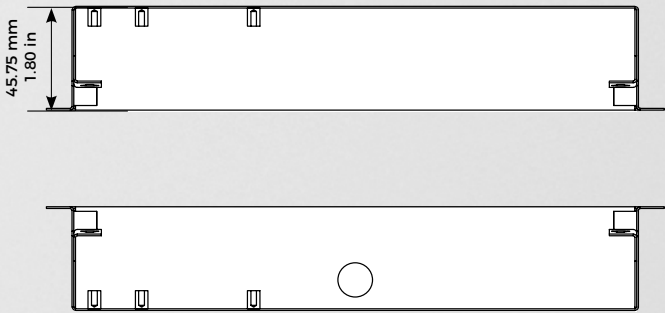

Flush-mounting housing (backbox)

This data sheet is valid for the following EANs (discontinued on August 1, 2021):

4260423860452

4260423866348

4260423868151