



A8008

4D SECURITY RADAR MOTION SENSOR

Compact design. Equipped with built-in relays to trigger alarms, activate lighting, or operate doors and gates

The 4D Radar Motion Sensor is a versatile solution for enhancing security and automation in any installation. It can trigger actions such as activating an alarm, summoning an elevator, opening doors, or turning on lights when motion is detected. Designed for both indoor and outdoor use, the sensor is compatible with any device (regardless of manufacturer) that supports dry-contact triggering. Additionally, it seamlessly integrates with the DoorBird IP Video Mini Dome Camera A1131, which can also serve as a power source for the sensor.

THE FEATURES

- Can be mounted on the wall using the wall mount adapter or on a tripod socket
- 4 motion detection modes (Off, Coming, Leaving, Coming and Leaving)
- Controller for Sensitivity, time, and day/night switchover

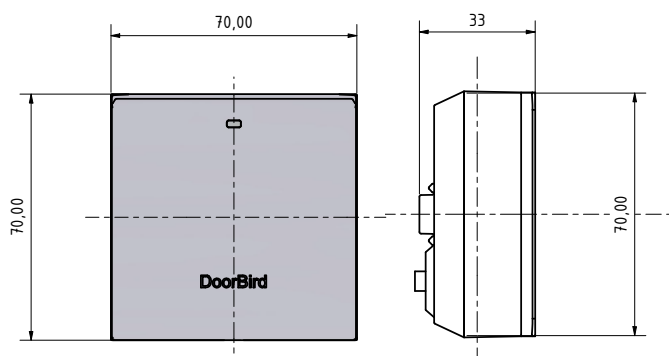

A8008 with wall mount adapter

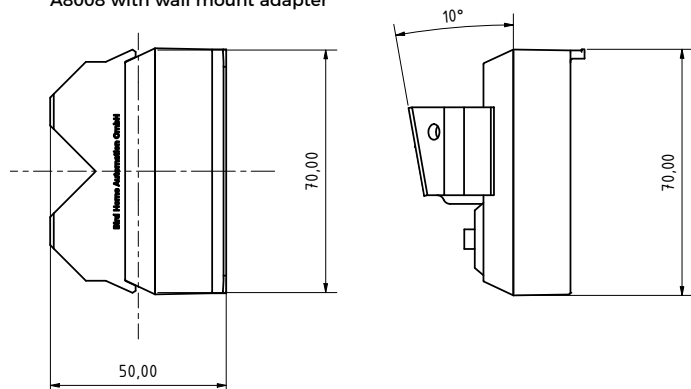

GENERAL

Material	Polycarbonate
Mounting type	Surface. Mounting brackets with two different angles included. Tripod thread DIN 4503-1 / ISO 1222 also supported.
Dimensions	33 x 70 x 70 mm (L x W x H) 1.30 x 2.75 x 2.75 in (L x W x H)
Power supply	48 V DC. Power supply unit not included.
Power consumptions	max. 1 W
Operating conditions	-25 to +55°C / -13 to 131°F Humidity 10 to 85 % RH (non-condensing)
Protection class	IP65
Approvals	CE, FCC, IC, RoHS, REACH, WEEE
Scope of delivery	1x 4D Security Radar Motion Sensor A8008 1x Installation manual 2x Connection cable 1x Wall mount adapter 1x Small Parts
Connectors	• 1x Bistable latching relay, max. 1 - 24 V DC/AC, 1 A, e.g. to trigger an alarm or turn on a light • 1x Bistable latching relay, max. 1 - 48 V DC/AC, 1 A, e.g. to trigger an alarm or turn on a light • 5 - 57 V DC input (+, -)
Controls	• LED on/off • Motion detection direction (Off, Coming, Leaving, Coming/Leaving) • LUX intensity • Trigger duration time of Relay 1, up to 15 min • Sensitivity / Distance of the Radar, 1 to 10m / 3.3 ft to 33 ft
LED	Motion detection
Weight	A8008: 67,5 g wall mount adapter: 10 g
EAN	4251489602148
Warranty	see www.doorbird.com/warranty
Garantie	siehe www.doorbird.com/warranty

MOTION SENSOR

Type	Active
Detection angle	54° (H), 70° (V)
Range	1 - 10 m (3.3 - 32.9 ft), depends on environment, configurable via rotary control.
Technology	4D, Based on multiple integrated sensors and algorithmy, e.g. Radio Frequency Energy (RFE)
Configuration	Via controls, e.g. • Range (1 - 10 m / 3.3 - 32.9 ft) • Movement direction (coming, leaving, both) • Day/night switchover

INTEGRATED WIRELESS MODULES

Sensor	24 GHz, can be disabled
--------	-------------------------

OPTIONAL ACCESSORIES

Sold separately	Power supply unit (main adaptor) with 4 country-specific outlet adaptors
-----------------	--